

Project:

Sprintech - Wallet

Due to possible design updates the parts shown in this manual may differ in appearance from the .STL documents you download from Printables.com or BuyMeaCoffee.com, but the manual can still be used as is.

Table of Contents

Wallet specifications	3
1. Print settings.....	4
2. Required hardware.....	4
Wallet parts.....	5
Wallet Assembly.....	6
1. Wallet Main body.....	6
2. Elastic band.....	7
Wallet cover	9
Legal	10

Wallet specifications

Material: Based on your preference.

(We recommend - Prusament PETg Galaxy Black)

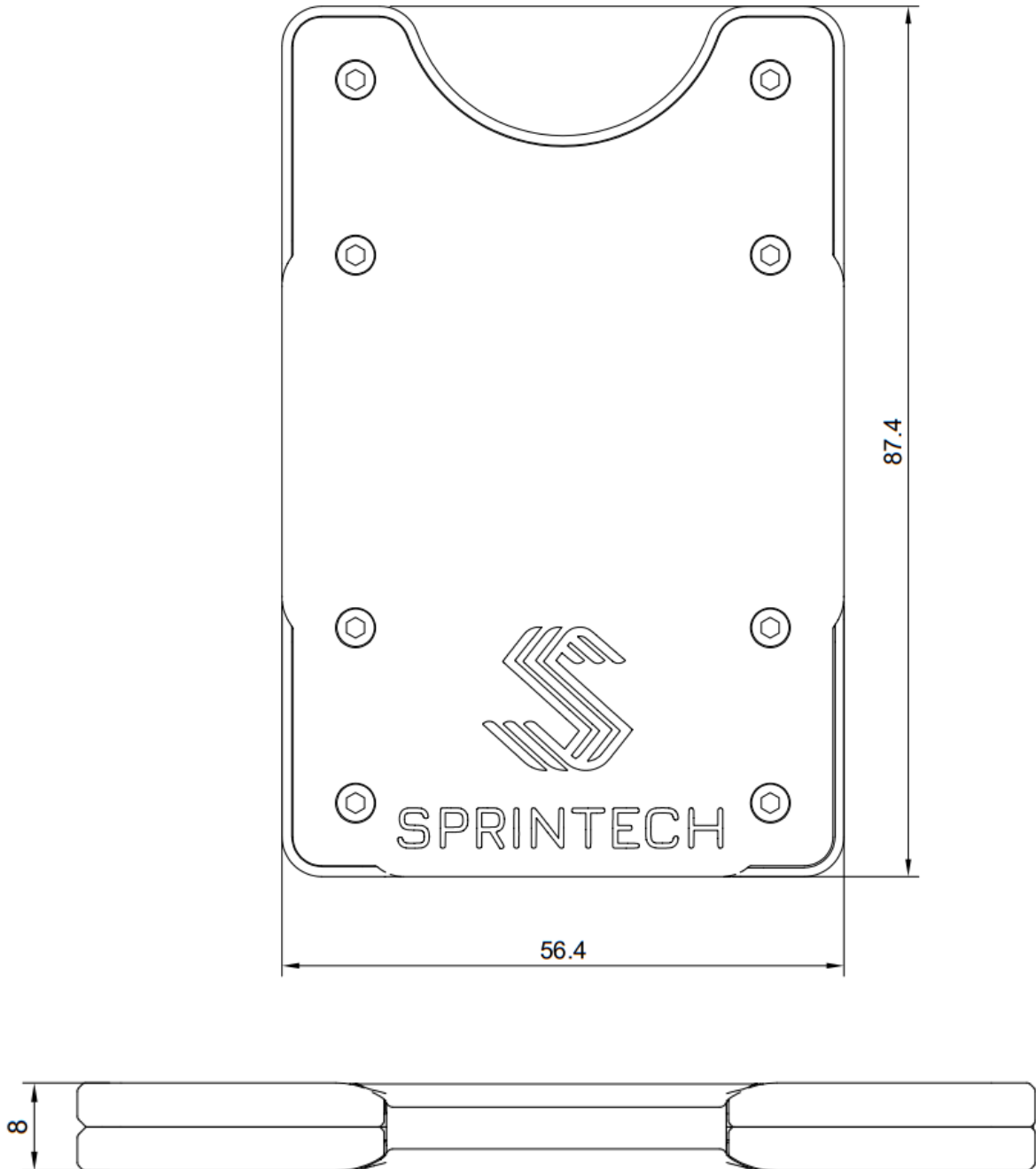

1. Print settings

(We recommend)

- Print all parts in the orientation provided in the .STL file you downloaded from [BuyMeaCoffee](#) page.
- Bed types: Textured PEI Plate
- Nozzle: 0.4 mm
- Layer height: 0.16 mm
- Wall Loops: 4
- Line width
 - Default: 0.42 mm
 - Outer wall: 0.52 mm
 - Bottom wall: 0.5 mm
- Top shell layer: 4
- Bottom shell layer: 4
- Infil: 100%

Note: The print quality depends on the printer and the material you use, as well as on how well the printer and material are calibrated. The images you see of the wallets and the quality they display on ([Printables](#) and [BuyMeaCoffee](#)) were achieved with a calibrated printer and material, resulting in high quality.

2. Required hardware

- 3D Printer or access to 3D printing service
- Screws:
 - [16x Brass insert M2xL2xOD3](#) + tools for inserting them.
 - [16x Countersunk Bolt Screw M2x3mm](#)
- [Elastic band High elastic 3cm - 3X47mm Grey](#)
- [UHU All Purpose Adhesive](#)
- Allen key

Wallet parts

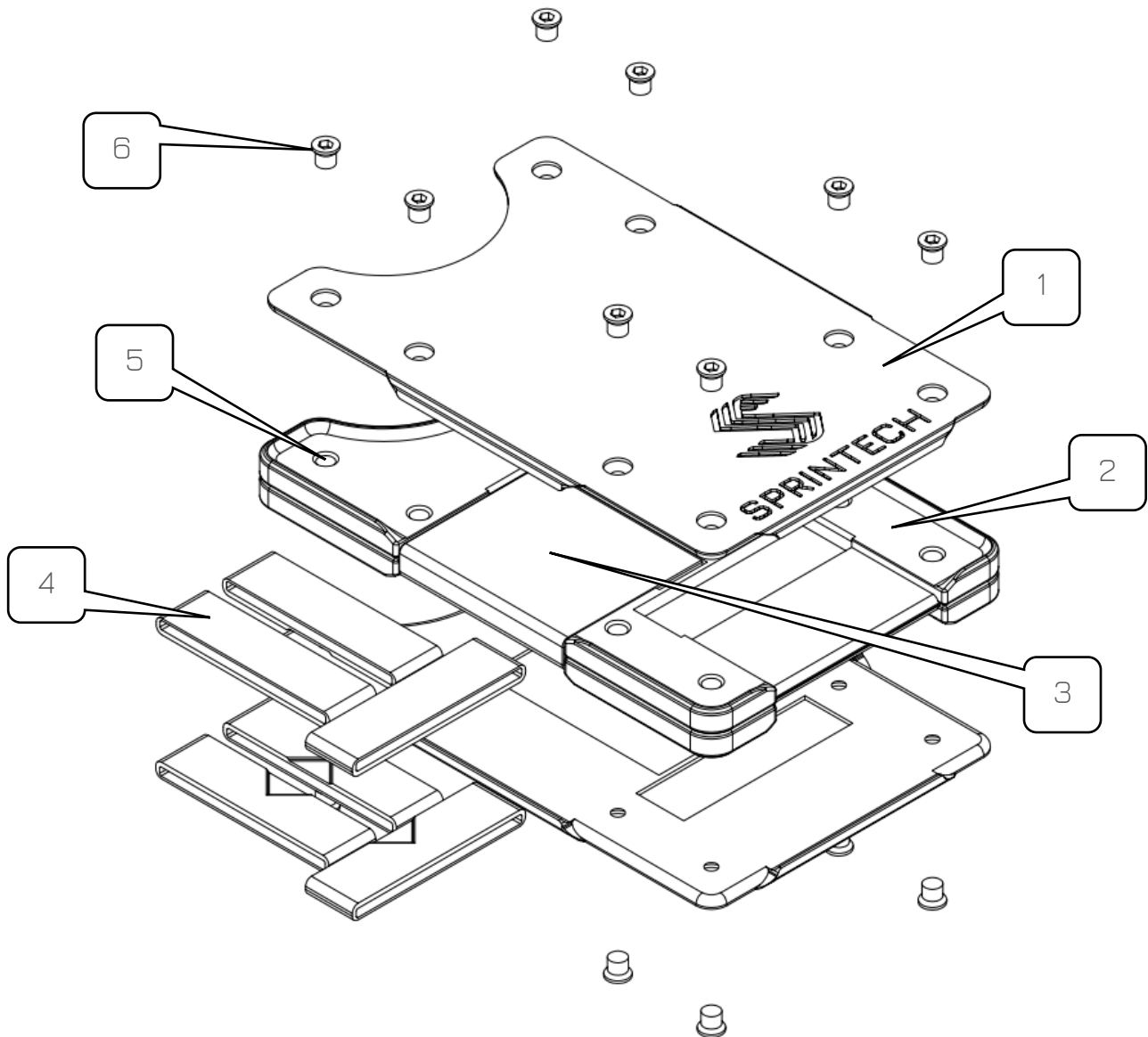

1. Wallet cover x2
2. Wallet Main body X2
3. Elastic band 3cm - 3X47mm
4. End caps for Elastic band
5. Holes for Brass insert M2xL2xOD3 16x
6. Countersunk Bolt Screw M2x3mm 16x

Wallet Assembly

Make sure you have printed all the necessary parts for the wallet, meaning everything included in the .STL file. Once you are satisfied with the quality of the printed parts, you can begin assembling the wallet.

1. Wallet Main body

It is necessary to insert the **brass threaded insert** into the corresponding holes (5), flush with the main body.

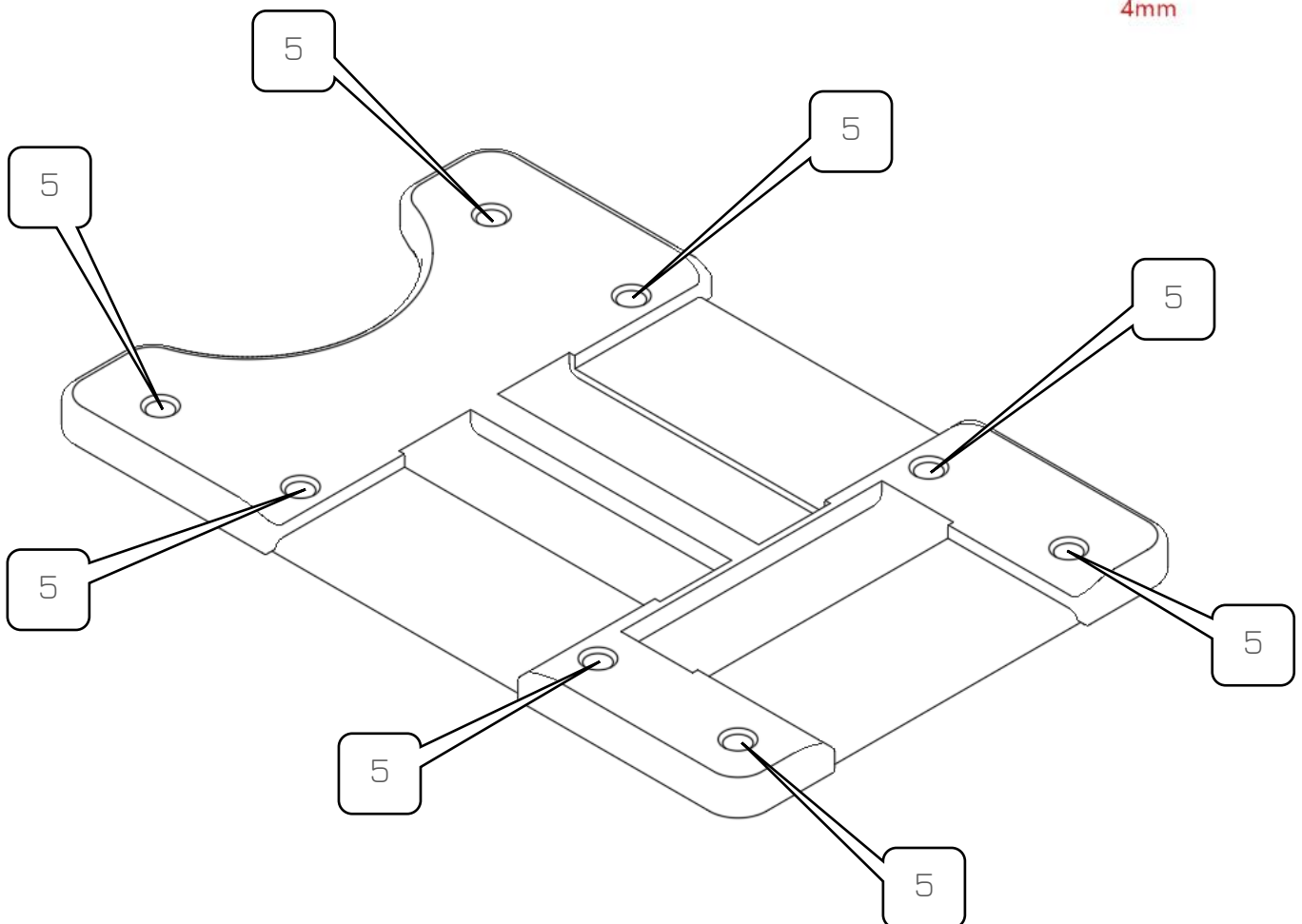

2. Elastic band

To make one wallet, you need 3 elastic bands cut to a length of 47mm.

1. You need to place the end caps on the elastic band as shown in the image below.
2. Apply UHU glue to the ends of the elastic band, covering approximately 6mm to 8mm in width on both sides of the band. Be careful not to apply too much glue.
3. Once you've applied the glue, slide the end caps onto the ends of the elastic band, as shown in the image. It is recommended to first apply glue to one side and slide on the end cap, then repeat for the other side. After sliding on the end caps, press them slightly to allow a small amount of glue to squeeze out from the elastic band for a better bond.

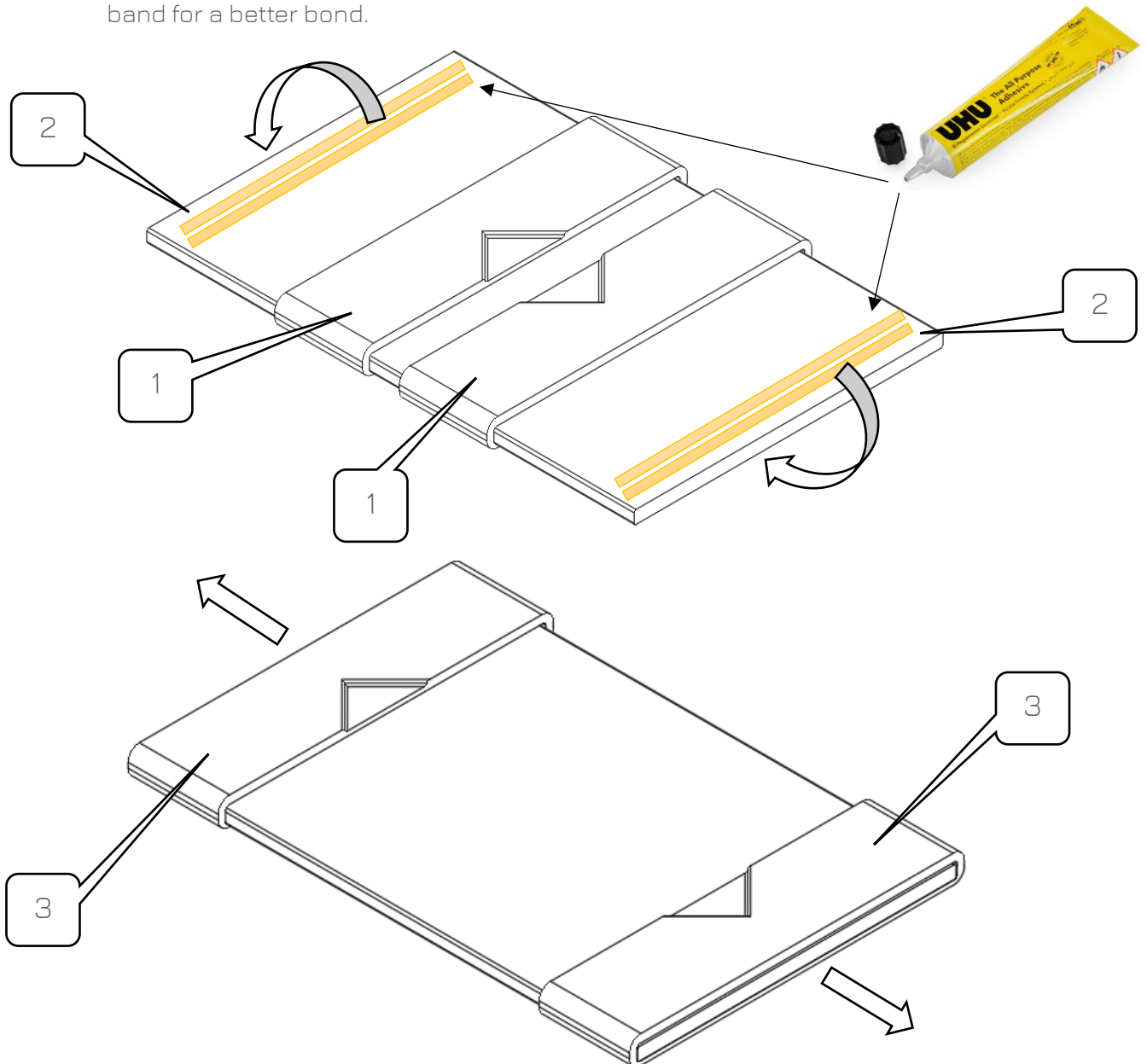

4. When the glue dries, you can attach the elastic band to the main body in such a way that the arrows face down toward the main body, so they are not visible. When you insert it into the appropriate slots, it should stay in place.

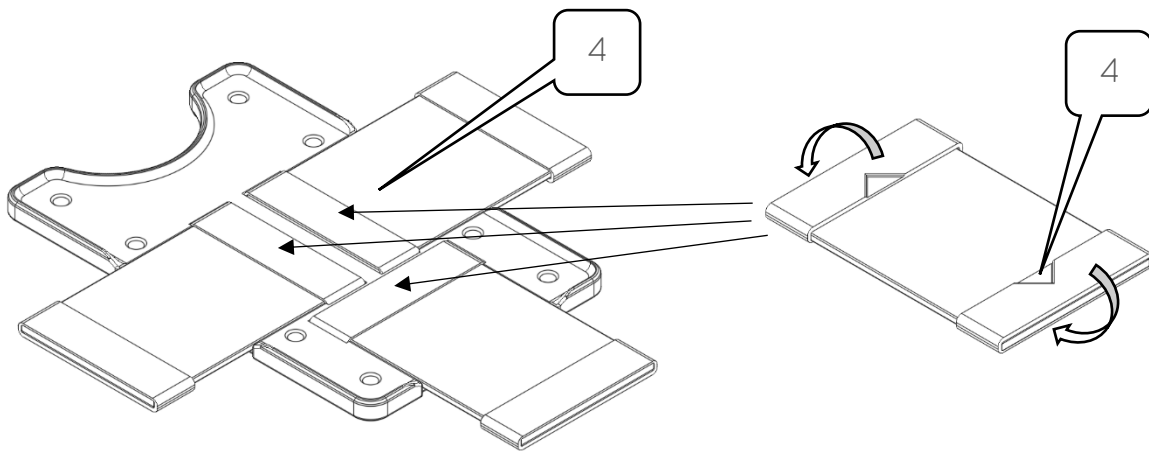

Wallet cover

1. When you attach the elastic band, you can place the **wallet cover** as shown in the picture.
2. Fasten all 8 screws.
3. Repeat steps 1 and 2 for the other side. Your wallet is complete =)

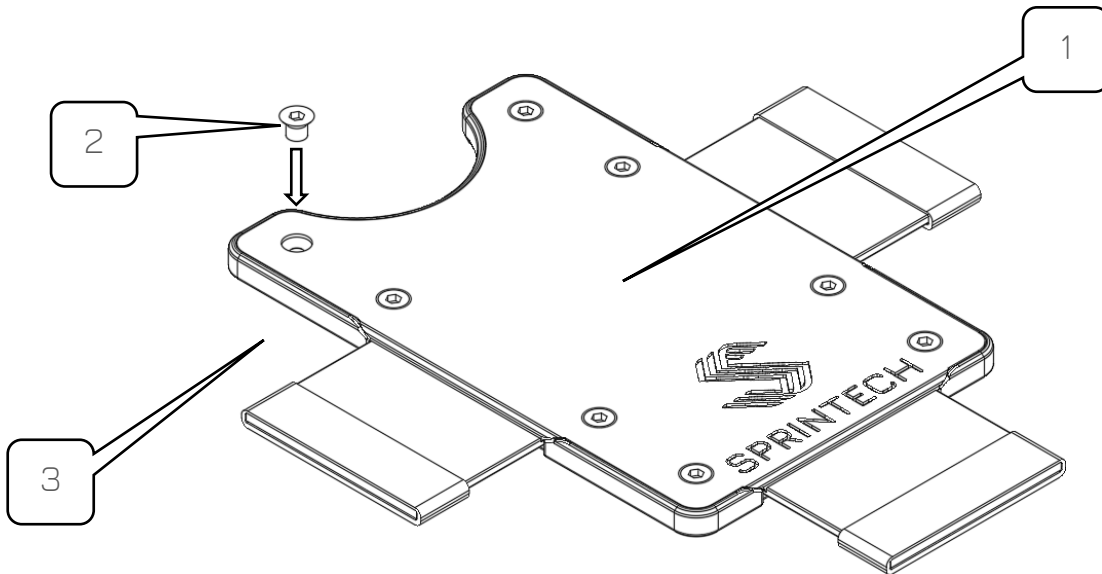

Legal

The copyright and distribution rights of images and designs contained in this document and related 3D-print files are intellectual property of **Sprintech.net**. The files are provided as is and for their strictly personal use. **Sprintech.net** will accept no liability for damages incurred by using these files nor from assembly and usage of the physical parts.